

NEW
ARRIVAL

PREMIER X SERIES



KLUDI
RAK

"We Stand for Water Saving"

PREMIER X SERIES



Modern Classic Masterpiece That Compliments With Every Style Statements

With superlative finish and premium quality and modern geometry blended with a classical touch Premier X is the next generation of KLUDI RAK's evergreen and hugely successful Premier series. Preserving the sustainable features of its pioneering model, Premier X is aimed to cater to your needs by offering a conventional but trendy design.

With a synergy of two distinct stylish controls, Premier X is a must-have budget-friendly fitting

- Easy Fix • Dual Controlled • Modern Classic Design • Exceptionally Conventional • Provision to Install Water-flow Regulator • Ideal for Low and High Water Pressure Setup • Bullnose Edge
- Chrome Plated Metal Cross Head Handle • Hot and Cold Marking • Highest Quality Brass Cartridge* • Swivel Tubular Spout • Chrome Plated Brass in Accordance to EN 50930-6



RAK34000

Dual controlled sink mixer DN15
metal handle
flow class A
deck mounted with swivel U spout
aerator M22 x 1
flexible hose
single hole mounted
in accordance to EN 200

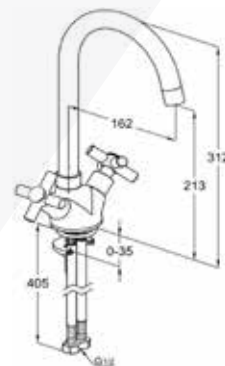

RAK34001

Dual controlled wall mounted sink
mixer DN15
flow class A
wall fastening
metal handle
swivel spout
aerator M22 x 1
outlet union 3/4 inch
S-unions 1/2 inch x 3/4 inch
in accordance to EN 200

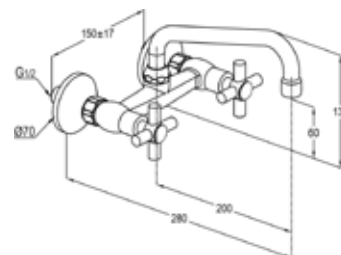

RAK34001SU

Dual controlled wall mounted sink
mixer DN15
flow class A
wall fastening
metal handle
swivel U spout
aerator M22 x 1
outlet union 3/4 inch
S-unions 1/2 inch x 3/4 inch
in accordance to EN 200

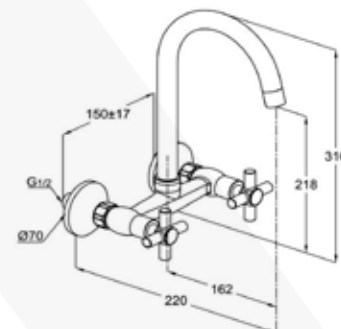



RAK34002

bibcock DN15
metal handle
wall fastening
thread connection 1/2 inch
hose union
marked : blue
in accordance to EN 200

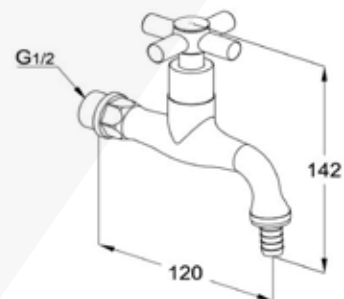

RAK34003

Stand pillar tap DN15
swivel U spout
metal handle
single hole mounted
marked : blue
aerator M22x1
flow class A
in accordance to EN 200

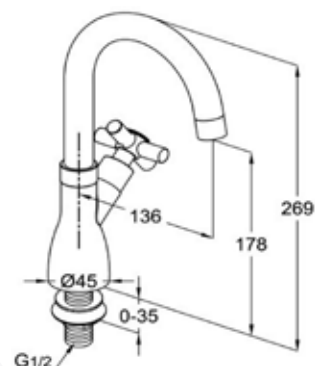

RAK34004

Dual controlled basin mixer DN15
metal handle
flow class A
swivel U spout
flexible hose
with pop up waste
single hole mounted
aerator M22 x 1
in accordance to EN 200

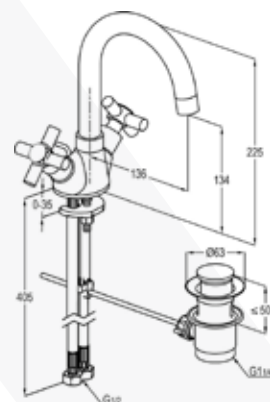



RAK34005

Dual controlled bath and shower mixer DN15
without shower set
metal handle, wall fastening
flow class CB
aerator M24x1
s unions 1/2 inch x 3/4 inch
automatic diverter : shower to bath tub
shower outlet 1/2 inch
in accordance to EN 200

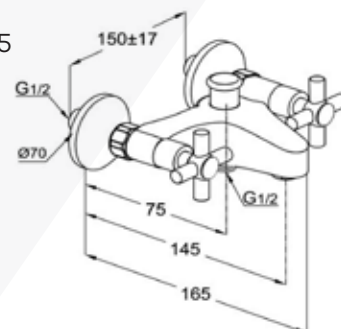

RAK34007

Long bibcock DN15
metal handle
flow class A
wall fastening
thread connection 1/2 inch
marked : blue
aerator M22 x 1
in accordance to EN 200

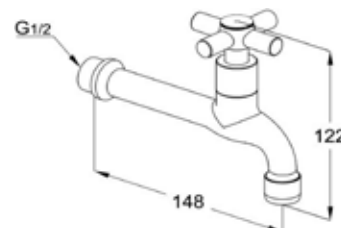

RAK34008

Wall mounted sink tap DN15
metal handle
swivel U spout
flow class A
single hole mounted
in accordance to EN 200
marked : blue
aerator M22x1
thread connection 1/2 inch

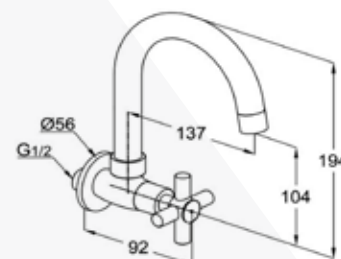



PREMIER  SERIES

www.kludirak.com



KLUDI
RAK

"We Stand for Water Saving"